



## TELESCOPIC PASSIVE WALL VENT

FG-A00186-001

# Installation Manual

White • 100 mm

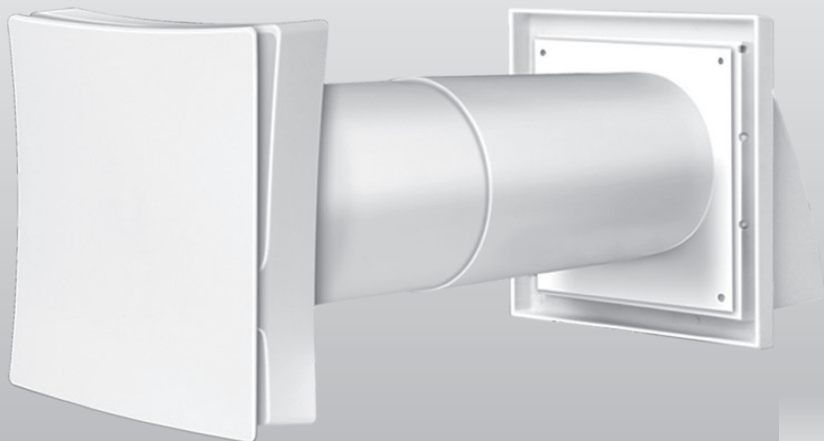

Thank you for choosing Dryzone®

Read all safety instructions before installing the unit.  
After installation, keep this guide for future reference.

**DO NOT DISCARD**

**DRYING  
HOMES**  
FOR OVER  
**40**  
**YEARS**  
EST 1983



# Contents

<b>Glossary</b> .....	<b>4</b>
<b>About Passive Vents</b> .....	<b>5</b>
<b>Box Contents</b> .....	<b>6</b>
Additional Items You WILL Need .....	6
Additional Items You MAY Need .....	6
<b>Product Diagrams and Features</b> .....	<b>7</b>
<b>Safety Instructions</b> .....	<b>8 – 9</b>
WARNING .....	9
<b>Pre-Installation Checklist</b> .....	<b>9</b>
<b>Installation</b> .....	<b>10 – 12</b>
Exterior Vent Installation .....	12
<b>Operating Instructions</b> .....	<b>12</b>
<b>Storage Safety</b> .....	<b>13</b>
<b>Warranty</b> .....	<b>13</b>
<b>Cleaning</b> .....	<b>14</b>
<b>Troubleshooting</b> .....	<b>15</b>
<b>Specifications</b> .....	<b>15</b>

*Before installing this product, consideration could be given to reference to relevant guidelines, legislation and best practice documentation for overall guidance.*

*Listed here are suggested documents applicable to building work carried out in England, however this is not an exhaustive list. Other relevant documents should be considered.*

*Separate relevant documents are available for countries other than England.*

*BS 5250:2021 Management of moisture in buildings*

*The Building Regulations 2010 Approved Document F Volume 1: Dwellings & Volume 2: Buildings other than dwellings*

*The Building Regulations 2010 Approved Document L – Conservation of fuel and power Volume 1: Dwellings*

*The Building Regulations 2010 Approved Document B – Fire Safety Volume 1: Dwellings 2019 edition incorporating 2020 and 2022 amendments*

*The Building Regulations 2010 Approved Document J – Combustion appliances and fuel storage systems 2010*

*The Building Regulations 2010 Approved Document P – Electrical safety – Dwellings 2013*

*NHBC Technical Standards*

*PAS 2035:2019 Retrofitting dwellings for improved energy efficiency*

*PCA Guidance Document: Positive Input Ventilation (PIV) Systems Issue 3 – June 2021*

*PCA Endorsed Joint Position Statement from Ventilation System Suppliers & Supporters – 1st Edition*

*IET Wiring Regulations, 18th Edition Amendment 2 (BS7671:2018+A2:2022)*

## Glossary

**Backdraught Shutter:** a flap that prevents cold air or odours from entering through the vent when airflow reverses. Often found in powered ventilation systems.

**Core Drill:** a cylindrical drill bit used to create a large hole through a wall, often required for installing ventilation ducts.

**Ducting:** tubing (flexible or rigid) that connects the interior vent to the outside wall, enabling air to pass through.

**Filter:** a mesh or fabric component inside the vent that traps dust or particles, helping maintain indoor air quality.

**Passive Ventilation:** a method of air movement that occurs naturally, without mechanical fans, using pressure differences between inside and outside.

**Spigot:** the pipe-like outlet at the back of the vent that fits into the ducting.

**Telescopic Duct:** an extendable section of ducting designed to fit a range of wall thicknesses by sliding in and out.

**Trickle Ventilation:** a form of continuous background ventilation where a small amount of air flows through, typically through wall vents or window trickle vents.

## About Passive Vents

A **passive vent** is a type of non-powered ventilation. It is designed to support natural airflow in and out of buildings without mechanical assistance. Removing stale, humid air helps improve air quality. Passive vents are most commonly fitted in habitable rooms like bedrooms and lounges.

The **Dryzone® Telescopic Passive Wall Vent White 100 mm** has been developed to improve indoor air quality and resolve condensation and mould problems. The telescopic ducting allows the passive vent to be fitted in a range of wall thicknesses. The installer should place the passive vent on an external wall, near the ceiling, above head height. It is recommended that the vent is regularly cleaned.

The vent requires no wiring.

# Box Contents

All packaging is certified as being either recyclable or compostable. Please dispose of all packaging using the correct recycling bin or bank.

- ☐ 1 × Internal Grille

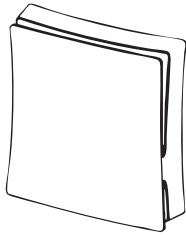

- ☐ 1 × Ventilation Hood

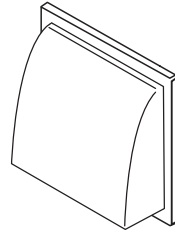

- ☐ 1 × Telescopic Duct

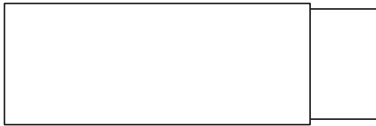

- ☐ 1 × Filter

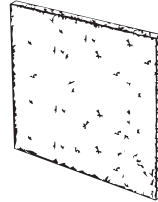

- ☐ 4 × Screws



- ☐ 4 × Wall Plugs



- ☐ 1 × Pull Cord



## Additional Items You WILL Need

- |  |                                     |
|--|-------------------------------------|
| <input type="checkbox"/> Cordless drill      | <input type="checkbox"/> Goggles    |
| <input type="checkbox"/> Suitable drill bits | <input type="checkbox"/> Pencil/pen |
| <input type="checkbox"/> Spirit level        | <input type="checkbox"/> PPE        |

## Additional Items You MAY Need

- ☐ 100 mm core drill

# Product Diagrams and Features

ALL DIMENSIONS ARE IN MILLIMETRES (mm)

## Internal Grille

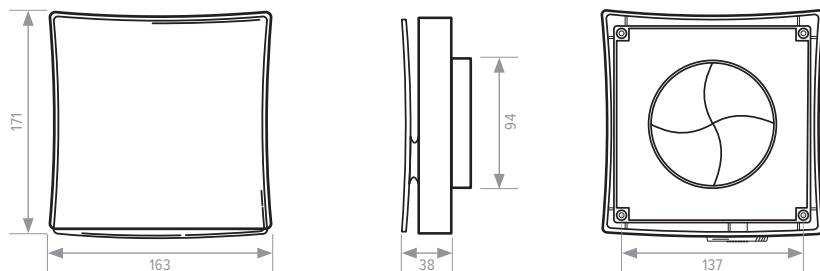

## Ventilation Hood

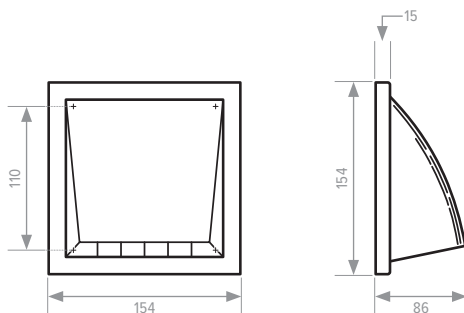

## Telescopic Duct

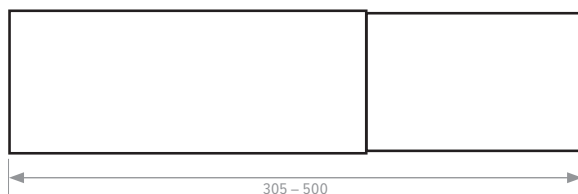

# Safety Instructions

## Read and understand these instructions prior to installation.

---

- The unit must be installed in compliance with The Building Regulations 2010: *Approved Document F*.
- Ventilation must be installed by a competent, qualified person and signed off by your local authority Building Control department.
- **THIS UNIT IS NOT INTENDED FOR USE BY CHILDREN.** Keep away from children and animals.
- This unit is not intended for use by persons with reduced physical, sensory or reasoning capabilities or lack of experience or knowledge unless they have been given supervision or instruction concerning the use of the unit by a person responsible for their safety.
- This unit is intended for domestic household and indoor use only. Do not use outdoors. Keep away from liquids.
- Only use this unit with supplied accessories and official Dryzone® replacement parts.
- Do not allow foreign objects to enter the ventilation or exhaust opening as this may cause damage to the unit. Do not block air outlets or intakes.
- Do not cover the unit while in use.
- Always follow basic precautions when using the unit to reduce the risk of fire and injury.
- If the unit is supplied with damage to any components or becomes damaged during use, do not use and immediately contact Safeguard Europe Customer Support for advice.
- Check for pipes and cables in the wall before drilling.

# Safety Instructions

## WARNING

- Failure to comply with these instructions could result in fire, damage to property, serious injury or death.
- The unit must not affect the operation of open-flue appliances. Consult local regulations or a qualified gas engineer.
- Take steps to prevent ingress of smoke, carbon monoxide and other combustion products into the room through open chimney flues or other fire-protection units. Sufficient air supply must be provided for proper combustion and exhaust of gases through the chimney of fuel burning equipment to prevent back drafting. Transported air must not contain any dust or other solid impurities, sticky substances, or fibrous materials.

## Pre-Installation Checklist

- ☐ Check that the unit fits in the area selected.
- ☐ Check there are no obstructions in the room where the vent is to be fitted and where the ducting is to be installed.
- ☐ Check for open-flued combustion appliances: refer to The Building Regulations 2010: *'Approved Document J: Combustion appliances and fuel storage systems'* and The Building Regulations 2010: *'Approved Document F: Ventilation: Volume 1 – Dwellings'* for guidance.
- ☐ Check if the presence of asbestos is possible: refer to the HSE publication *'Managing and working with asbestos – Control of Asbestos Regulations 2012'* for guidance.

# Installation

These instructions assume that a qualified person has:

- Identified the ventilation needs of the property.
- Prepared a suitable size core drill hole or one already exists.

The Dryzone® Passive Vent is designed for wall mounting inside a round Ø 100 mm hole.

## DUCTING AND INTERNAL GRILLE

1

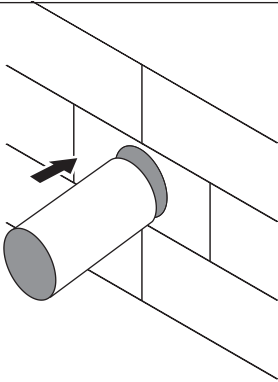

Insert the telescopic ducting into the pre-drilled 100 mm hole.

2

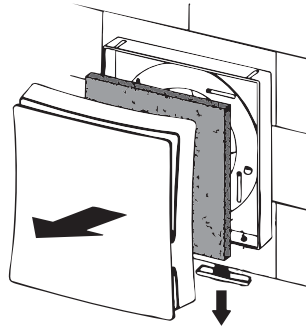

Slide the toggle on the bottom to remove the front panel and filter of the vent.

3

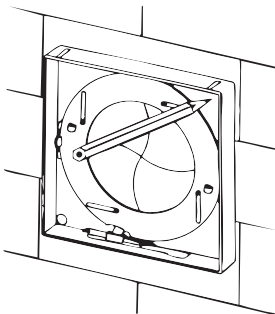

Mark up the screw holes with pen/pencil.

4

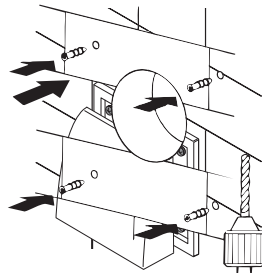

Drill the mounting holes and install the wall plugs.

# Installation

## DUCTING AND INTERNAL GRILLE (CONTINUED)

5

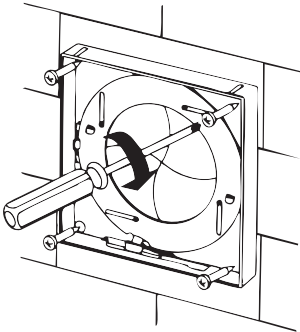

Fix the frame with the screws, ensure the spigot is correctly aligned at the back.

6

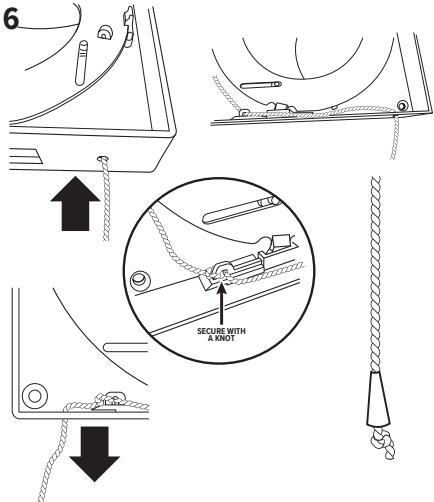

Insert the pull cord through the hole. Channel it along the bottom and through the hoop. Tie a knot and then pull through the remaining hole.

7

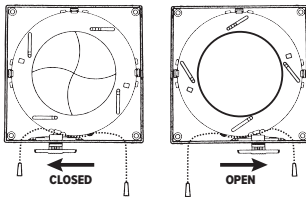
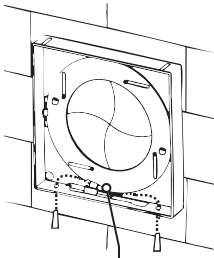

Operate the open/shut function.

8

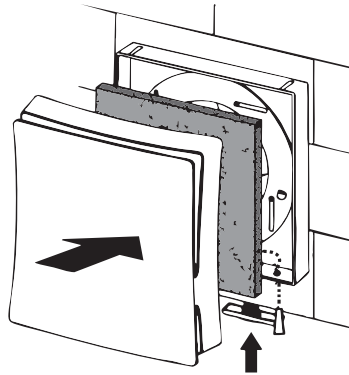

Insert the filter and clip the cover on the front.

# Installation

## EXTERIOR VENT

1

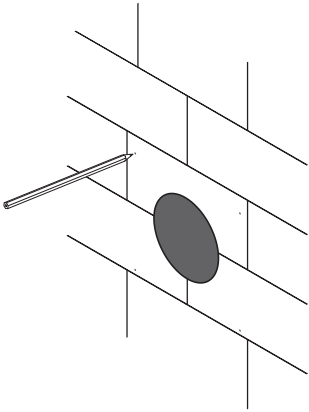

Mark up the screw holes with pen/pencil.

6

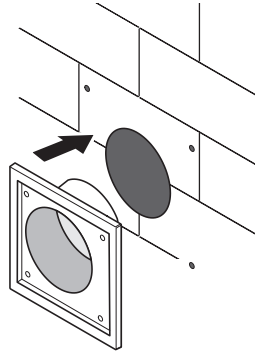

Drill the mounting holes.

7

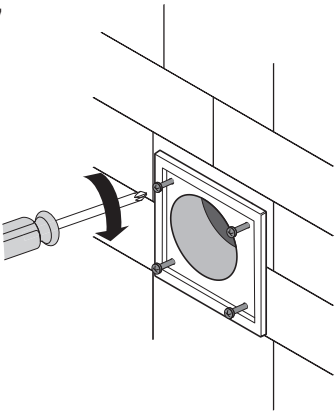

Fix the frame with the screws.

8

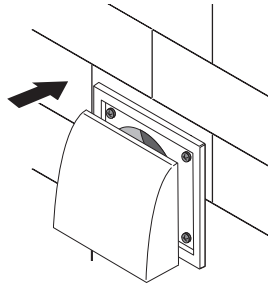

Attach the ventilation hood.

## Operating Instructions

This passive vent has no electronic parts or controls. It operates continuously based on natural air pressure differences.

The resident is able to adjust the aperture, and therefore control the airflow, by adjusting the slide control on the internal grille.

## Storage Safety

- The storage environment must not contain aggressive vapours and chemical mixtures provoking corrosion, insulation and sealing deformation.
- The unit can be carried in the original packaging by any mode of transport provided proper protection against precipitation and mechanical damage. The unit must be transported only in the working position.
- Avoid sharp blows, scratches or rough handling during loading and unloading.

## Warranty

We appreciate you choosing this quality Dryzone® product, which has been designed and manufactured to the highest specification. We are confident that you will be delighted with the performance of this system and the resulting air quality improvement in your home after the installation of the unit.

This unit is covered by a full 5-year warranty.

The warranty covers any defect or breakdown that arises due to faulty materials or construction. Please note that a receipt will be required as proof of purchase. This device can only be used with official Dryzone® parts, supplied by Safeguard Europe Ltd. Repairs with parts from any other source voids this warranty.

The warranty does not cover any labour.

For warranty conditions and exclusions, visit: [www.safeguardeurope.com/warranty](http://www.safeguardeurope.com/warranty)

# Cleaning

- Maintenance means regularly cleaning dirt and dust from the vent. To ensure optimal performance, it is recommended that you clean it once every 6 months.
- Filters should be replaced every 12 months.
- Remove the front panel, wipe the vent with a dry cloth or a brush
- Vacuum filter
- Clean the front panel under running water
- Wipe the vent surfaces dry
- Ensure all components are dry before re-assembling

1

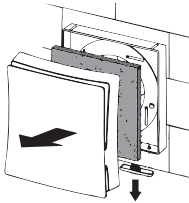

2

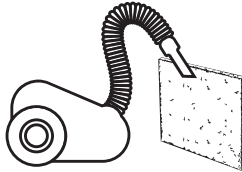

3

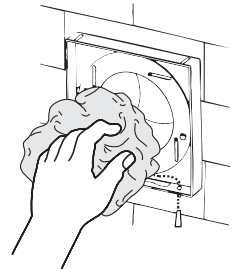

4

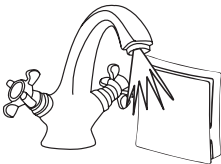

5

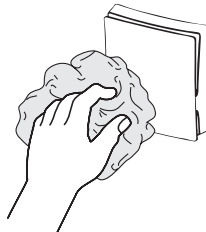

6

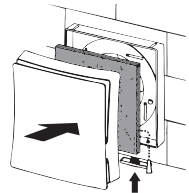

# Troubleshooting

Please troubleshoot, using the table below, before contacting Customer Support:

MALFUNCTION	PROBABLE REASONS	REMEDY
Low airflow	Clogged ventilation system	Clean the vent and ducting where possible

# Specifications

Diameter ø [mm]	100
Length	Walls up to 500 mm
Colour	White
Weight [kg]	0.68 kg



**UK:** Safeguard Europe Ltd.,  
Redkilyn Close, Horsham, West Sussex, RH13 5QL.

**T** +44 (0)1403 210204

**F** +44 (0)1403 217529

**E** [info@safeguardeurope.com](mailto:info@safeguardeurope.com)

**DE:** Safeguard Europe GmbH,  
Hamburger Straße 11, 22083 Hamburg, Deutschland.

**T** +49 40 87407563

**F** +49 4822 3657868

**E** [info@safeguardeurope.de](mailto:info@safeguardeurope.de)

